

PEER-LIFT™

GALVANIZED ANCHOR SHACKLES

- MEET OR EXCEED FED SPEC RR-C-271D REQUIREMENTS
- MEET ASME B30.26 REQUIREMENTS
- HOT DIPPED GALVANIZED TO ASTM A153
- ULTIMATE LOAD AT 6 TIMES THE WLL
- PROOF LOAD AT 2 TIMES THE WLL



©2009 Peerless Chain Company, 27.31 2/09



PEERLESS
INDUSTRIAL GROUP
Your Link to Quality, Strength, and Service Since 1917.

Corporate Headquarters:
1416 East Sanborn St.
P.O. Box 5349
Winona, MN 55987-0349

Phone: (800) 873-1916
Fax: (800) 356-1149
Internet: www.peerlesschain.com
Email: custserv@peerlesschain.com

SCREW PIN ANCHOR SHACKLES ARE IDEAL FOR THOSE APPLICATIONS WHERE FREQUENT PIN REMOVAL IS NEEDED.



PEERLESS
INDUSTRIAL GROUP

Your Link to Quality, Strength, and Service Since 1917.

SAFETY PIN ANCHOR SHACKLES ARE COMPLETE WITH BOLT, NUT AND COTTER PIN. USE THESE IN APPLICATIONS WHERE PIN REMOVAL IS MINIMAL.

PEERLESS JEANNETTE WEISSENFELS USA

Phone: (800) 873-1916 • Web: www.peerlesschain.com

SCREW PIN ANCHOR SHACKLES - Forged CARBON Steel Body with ALLOY Pins, Galvanized

Stock No.	Size	WLL (tons)	WLL (lbs)	Pin Dia.	DIMENSIONS IN INCHES			Package Qty	Carton Weight
					A	B	C		
8058105	3/16"	1/3T	665	1/4"	9/16"	7/8"	3/8"	250	15 lbs
8058205	1/4"	1/2T	1,000	5/16"	3/4"	1-1/8"	15/32"	250	28 lbs
8058305	5/16"	3/4T	1,500	3/8"	13/16"	1-1/4"	17/32"	150	29 lbs
8058405	3/8"	1T	2,000	7/16"	15/16"	1-7/16"	21/32"	100	31 lbs
8059205	7/16"	1-1/2T	3,000	1/2"	1-1/16"	1-11/16"	23/32"	100	38 lbs
8058505	1/2"	2T	4,000	5/8"	1-3/16"	1-7/8"	13/16"	50	36 lbs
8058605	5/8"	3-1/4T	6,250	3/4"	1-1/2"	2-13/32"	1-1/16"	25	34 lbs
8058705	3/4"	4-3/4T	9,500	7/8"	1-3/4"	2-27/32"	1-1/4"	25	63 lbs
8058805	7/8"	6-1/2T	13,000	1"	2"	3-5/16"	1-7/16"	10	36 lbs
8058905	1"	8-1/2T	17,000	1-1/8"	2-5/16"	3-3/4"	1-11/16"	10	50 lbs
8058005	1-1/8"	9-1/2T	19,000	1-1/4"	2-5/8"	4-1/4"	1-13/16"	5	37 lbs
8059005	1-1/4"	12T	24,000	1-3/8"	2-7/8"	4-11/16"	2-7/32"	5	48 lbs
8059305	1-3/8"	13-1/2T	27,000	1-1/2"	3-1/4"	5-1/4"	2-1/4"	5	68 lbs
8059105	1-1/2"	17T	34,000	1-5/8"	3-3/8"	5-3/4"	2-3/8"	5	86 lbs
8059405	1-3/4"	25T	50,000	2"	4-1/2"	7"	2-7/8"	1	27 lbs
8059505	2"	35T	70,000	2-1/4"	5-1/4"	7-3/4"	3-1/4"	1	42 lbs

RR-C-271 D
Type 1VA, Grade A, Class 2

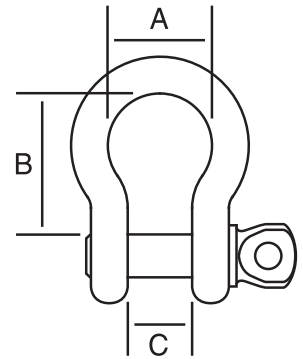

SAFETY PIN ANCHOR SHACKLES - Forged CARBON Steel Body with ALLOY Pins, Galvanized

Stock No.	Size	WLL (tons)	WLL (lbs)	Pin Dia.	DIMENSIONS IN INCHES			Package Qty	Carton Weight
					A	B	C		
8063005	3/16"	1/3T	665	1/4"	9/16"	7/8"	3/8"	250	15 lbs
8063105	1/4"	1/2T	1,000	5/16"	3/4"	1-1/8"	15/32"	250	28 lbs
8063205	5/16"	3/4T	1,500	3/8"	13/16"	1-1/4"	17/32"	150	33 lbs
8063305	3/8"	1T	2,000	7/16"	15/16"	1-7/16"	21/32"	100	37 lbs
8063405	7/16"	1-1/2T	3,000	1/2"	1-1/16"	1-11/16"	23/32"	100	51 lbs
8063505	1/2"	2T	4,000	5/8"	1-3/16"	1-7/8"	13/16"	50	40 lbs
8063605	5/8"	3-1/4T	6,250	3/4"	1-1/2"	2-13/32"	1-1/16"	25	42 lbs
8063705	3/4"	4-3/4T	9,500	7/8"	1-3/4"	2-27/32"	1-1/4"	25	68 lbs
8063805	7/8"	6-1/2T	13,000	1"	2"	3-5/16"	1-7/16"	10	40 lbs
8063905	1"	8-1/2T	17,000	1-1/8"	2-5/16"	3-3/4"	1-11/16"	10	57 lbs
8064005	1-1/8"	9-1/2T	19,000	1-1/4"	2-5/8"	4-1/4"	1-13/16"	5	41 lbs
8064105	1-1/4"	12T	24,000	1-3/8"	2-7/8"	4-11/16"	2-7/32"	5	59 lbs
8064205	1-3/8"	13-1/2T	27,000	1-1/2"	3-1/4"	5-1/4"	2-1/4"	5	79 lbs
8064305	1-1/2"	17T	34,000	1-5/8"	3-3/8"	5-3/4"	2-3/8"	5	104 lbs
8064405	1-3/4"	25T	50,000	2"	4-1/2"	7"	2-7/8"	1	34 lbs
8064505	2"	35T	70,000	2-1/4"	5-1/4"	7-3/4"	3-1/4"	1	52 lbs

RR-C-271 D
Type 1VA, Grade A, Class 3

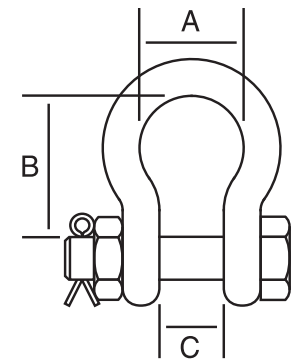

ALLOY SCREW PIN ANCHOR SHACKLES - Forged ALLOY Steel Body with ALLOY Pins, Galvanized

Stock No.	Size	WLL (tons)	WLL (lbs)	Pin Dia.	DIMENSIONS IN INCHES			Package Qty	Carton Weight
					A	B	C		
8058103	3/16"	1/2T	1,000	1/4"	9/16"	7/8"	3/8"	250	15 lbs
8058203	1/4"	3/4T	1,500	5/16"	3/4"	1-1/8"	15/32"	250	28 lbs
8058303	5/16"	1T	2,000	3/8"	13/16"	1-1/4"	17/32"	150	29 lbs
8058403	3/8"	2T	4,000	7/16"	15/16"	1-17/32"	21/32"	100	31 lbs
8059203	7/16"	2-2/3T	5,333	1/2"	1-1/16"	1-11/16"	23/32"	100	49 lbs
8058503	1/2"	3 1/3T	6,665	5/8"	1-3/16"	1-7/8"	13/16"	50	37 lbs
8058603	5/8"	5T	10,000	3/4"	1-1/2"	2-13/32"	1-1/16"	25	34 lbs
8058703	3/4"	7T	14,000	7/8"	1-3/4"	2-27/32"	1-1/4"	25	59 lbs
8058803	7/8"	9-1/2T	19,000	1"	2"	3-5/16"	1-17/32"	10	36 lbs
8058903	1"	12 1/2T	25,000	1-1/8"	2-5/16"	3-3/4"	1-11/16"	10	51 lbs
8059003	1-1/4"	18T	36,000	1-3/8"	2-7/8"	4-11/16"	2-7/32"	5	48 lbs
8059103	1-1/2"	25T	50,000	1-5/8"	3-3/8"	5-3/4"	2-3/8"	5	89 lbs
8059403	1-3/4"	34T	68,000	2"	4-1/2"	7"	2-7/8"	1	30 lbs
8059503	2"	43T	86,000	2-1/4"	5-1/4"	7-3/4"	3-1/4"	1	45 lbs

RR-C-271 D
Type 1VA, Grade B, Class 2

